

WestLab Audio

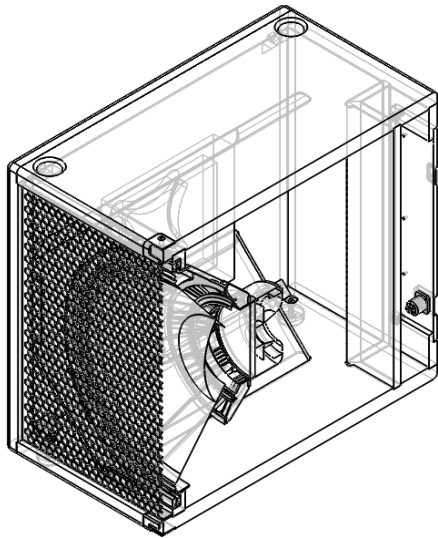

Product Data

18" Sub

Series: LABSUB

Model: LABSUB 18p (passive)

Dimensions H 544 x W 654 x D 600 mm

Local Box H 565 x W 690 x D 615 mm

Export Box H 620 x W 760 x D 670 mm

Net weight 47 kg

Export boxed 53,5 kg

Power Handling (RMS/Program/Peak)	1250/2000/4000 W
Nominal Impedance	8 Ohm
Sensitivity (1W/1m)	102 dB
Max SPL (peak)	134 dB
Frequency Range	28 Hz - 120 Hz
Free Field Frequency Response	30 Hz - 150 Hz
reg. Crossover Frequency	100 Hz
Directivity	Omnidirectional Cardioid / Hypercardioid in Clusters
Low Frequency Driver Chassis type	driven with Labcon MK2
Low Frequency Driver Magnet	Cone driver, port loaded
Low Frequency Driver Chassis diameter	Neodymium
Low Frequency Driver Voicecoil diameter	18" / 458 mm
	4" / 101,6 mm